

Energized Innovation

Sarasota

Chicago

India

Veethree
Instruments

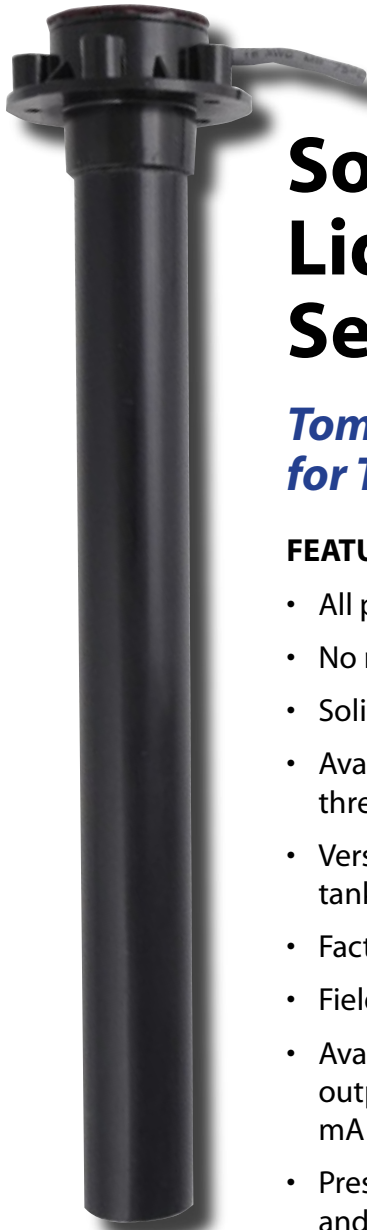

Solid State Liquid Level Sender (LLS)

*Tomorrow's Fuel Sender
for Today's Tanks!*

FEATURES AND BENEFITS:

- All plastic design to minimize corrosion issues
- No moving parts to fail
- Solid state electronics
- Available in SAE 5 hole mounting pattern or threaded 1½ NPT mounting
- Versions available for vented tanks or pressurized tanks
- Factory preset lengths available
- Field adjustable by cutting to length
- Available in the most popular analog resistance outputs or J1939, NMEA2000, 0-5 VDC and 4-20 mA versions
- Preset units available with a low fuel light feature and/or volumetric measurement configured to give volume information, not simply tank level
- Tubular design self dampens the gauge pointer movement from fuel slosh

 **MADE
IN THE
U.S.A.**
**U.S. PATENT
PENDING**

AT A GLANCE

LIQUID LEVEL SENDER SPECIFICATIONS:

- 12 and 24 VDC versions
- CE certified and meets SAE J1113 EMI / RFI
- -40C to +85C operational
- -54C to +85C storage
- ASTM B117, 300 hours salt spray
- UV stabilized to SAE J2020, 1000 hours
- Meets or exceeds SAE J1810 vibration testing for chassis mounted senders
- Meets or exceeds shock to three, half sine 10±1g shocks of 12 ms±1ms duration in all three axis
- Altitude tested for shipment in commercial aircraft
- Size range 6" - 60" lengths
- Must be top mounted

***For more information
and order placement
please contact
Veethree Customer Service:
941-538-7775***

Veethree Electronics and Marine LLC
2420 Trailmate Drive, Sarasota, Florida 34243 USA
www.v3instruments.com | 1-941-538-7775 | Fax: 1-941-755-1222

Veethree
Instruments

HIGHLIGHTS

MEASUREMENT TECHNOLOGY

- A medical grade pressure transducer mounted in the flange senses the pressure change inside the tube as the fuel level changes.

PRODUCT FEATURES

- Length 12" and under = +/-3% of tank depth.
Length 12" to 24" = +/-2% of tank depth.
Lengths over 24" = +/-1% of tank depth.
- Solid State electronics increases reliability due to no moving parts.
- Versions to match 33-240 ohm, 10-180 ohm, SAE J1939, NMEA 2000, 0-5 VDC or 4-20mA outputs so you can use your existing gauge designs.

EASY TO INSTALL

- Mounting options: SAE 5 hole flange design or 1½" NPT fitting in tank.
- Field adjustable by cutting to length and calibrating or can be ordered preset at the factory for depth.
- Tube design eliminates the bending and rotation of a float arm type sender
- Simply connect power, ground and connect sender wire to the gauge.

AVAILABLE FEATURES

- Factory units can be configured for volumetric information and/or include a low fuel light output.

MECHANICAL AND DIGITAL FILTERING

- Tube design self dampens slosh.
- Electronics can add additional filtering for excessive slosh if required.

FLUID COMPATIBILITY

- Unit works in a variety of different fuel types and fluids, including gasoline, diesel, oils, hydraulic fluids, waters used as fuels, etc.

CORROSIONS RESISTANCE

- All plastic design minimizes any issues related to corrosion from the measured fluid or harsh environments.

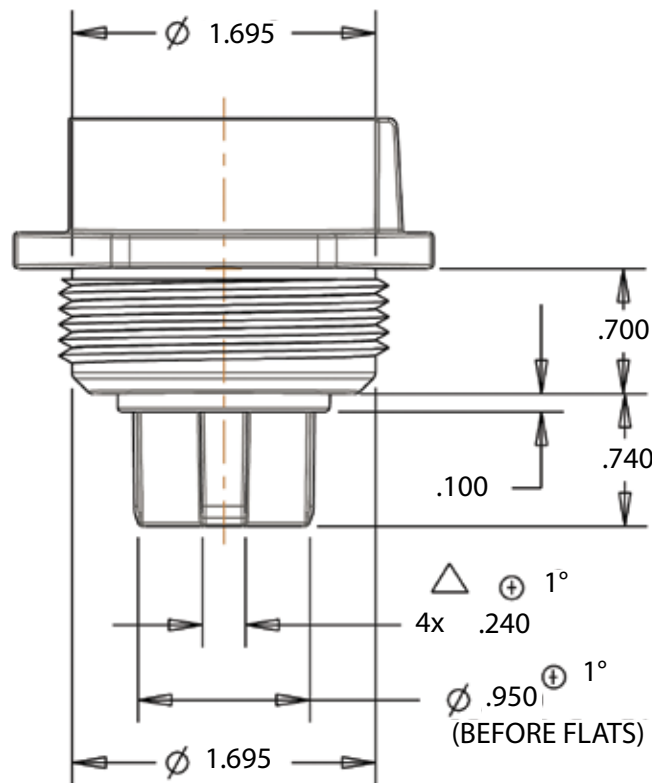
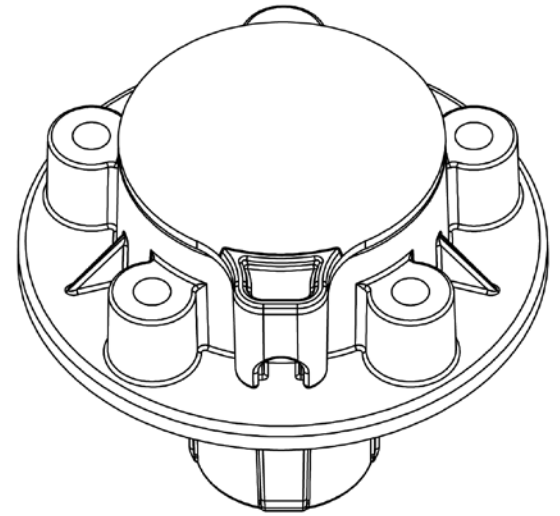
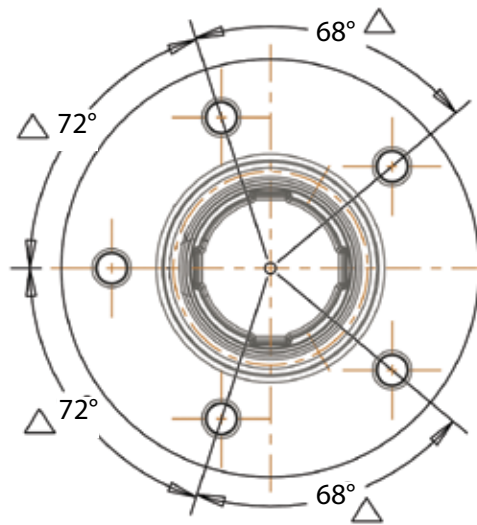

FRONT VIEW

